



NOW TAKING
RESERVATIONS



CASCADEWEST.COM



LOT SIZES

- 1 - 11,072 SF
- 2 - 11,655 SF
- 3 - 7,754 SF
- 4 - 7,946 SF
- 5 - 10,053 SF
- 6 - 7,825 SF
- 7 - 7,350 SF
- 8 - 7,525 SF
- 9 - 7,350 SF
- 10 - 8,021 SF
- 11 - 9,568 SF
- 12 - 9,302 SF
- 13 - 8,632 SF
- 14 - 7,394 SF
- 15 - 8,422 SF
- 16 - 9,229 SF
- 17 - 8,682 SF
- 18 - 7,771 SF
- 19 - 8,778 SF
- 20 - 8,779 SF
- 21 - 7,350 SF
- 22 - 9,051 SF
- 23 - 10,969 SF
- 24 - 8,417 SF
- 25 - 8,150 SF
- 26 - 7,406 SF
- 27 - 7,314 SF
- 28 - 7,944 SF
- 29 - 9,399 SF
- 30 - 7,652 SF
- 31 - 7,350 SF
- 32 - 7,350 SF
- 33 - 7,350 SF
- 34 - 7,350 SF
- 35 - 7,350 SF
- 36 - 7,350 SF
- 37 - 7,350 SF
- 38 - 7,810 SF
- 39 - 7,825 SF
- 40 - 7,700 SF
- 41 - 8,054 SF
- 42 - 9,051 SF
- 43 - 9,870 SF
- 44 - 9,210 SF
- 45 - 8,277 SF
- 46 - 9,415 SF
- 47 - 7,700 SF
- 48 - 7,825 SF
- 49 - 7,350 SF



Schools 

(E) Dorothy Fox
(M) Skyridge
(H) Camas

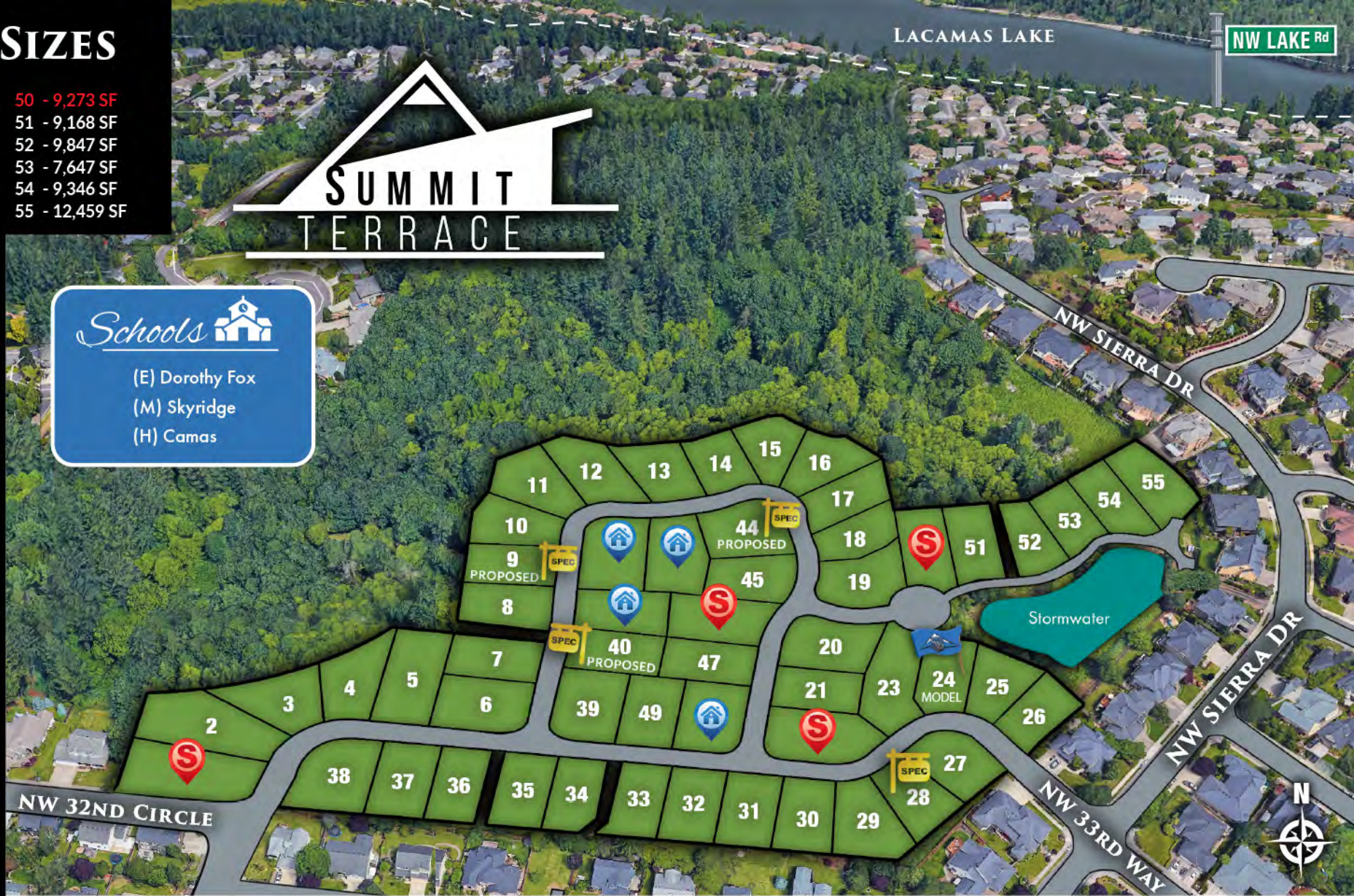

-  AVAILABLE LOTS
-  MODEL HOME
-  CURRENTLY RESERVED
-  SOLD

• Greenbelted • Southern Exposure • Top-Tier Schools • Close to Lacamas Lake & Nearby Parks

We are currently breaking ground and building our Model Home in this housing community on the highly desirable Prune Hill in Camas. This peaceful setting offers territorial views of nearby Lacamas Lake and the surrounding area. This community is scenic, but accessible — within 5 min of Downtown Camas, 30 min to Downtown Portland and 20 min to Downtown Vancouver.



Ron Wagner
360.907.4739



Jason Stenersen
360.772.2357



Chad Naeve
360.609.0111

