



NOW TAKING  
**RESERVATIONS**



[CASCADEWEST.COM](http://CASCADEWEST.COM)





# LOT SIZES

- 1 - 11,072 SF
- 2 - 11,655 SF
- 3 - 7,754 SF
- 4 - 7,946 SF
- 5 - 10,053 SF
- 6 - 7,825 SF
- 7 - 7,350 SF
- 8 - 7,525 SF
- 9 - 7,350 SF
- 10 - 8,021 SF
- 11 - 9,568 SF
- 12 - 9,302 SF
- 13 - 8,632 SF
- 14 - 7,394 SF
- 15 - 8,422 SF
- 16 - 9,229 SF
- 17 - 8,682 SF
- 18 - 7,771 SF
- 19 - 8,778 SF
- 20 - 8,779 SF
- 21 - 7,350 SF
- 22 - 9,051 SF
- 23 - 10,969 SF
- 24 - 8,417 SF
- 25 - 8,150 SF
- 26 - 7,406 SF
- 27 - 7,314 SF
- 28 - 7,944 SF
- 29 - 9,399 SF
- 30 - 7,652 SF
- 31 - 7,350 SF
- 32 - 7,350 SF
- 33 - 7,350 SF
- 34 - 7,350 SF
- 35 - 7,350 SF
- 36 - 7,350 SF
- 37 - 7,350 SF
- 38 - 7,810 SF
- 39 - 7,825 SF
- 40 - 7,700 SF
- 41 - 8,054 SF
- 42 - 9,051 SF
- 43 - 9,870 SF
- 44 - 9,210 SF
- 45 - 8,277 SF
- 46 - 9,415 SF
- 47 - 7,700 SF
- 48 - 7,825 SF
- 49 - 7,350 SF



*Schools* 

(E) Dorothy Fox  
(M) Skyridge  
(H) Camas

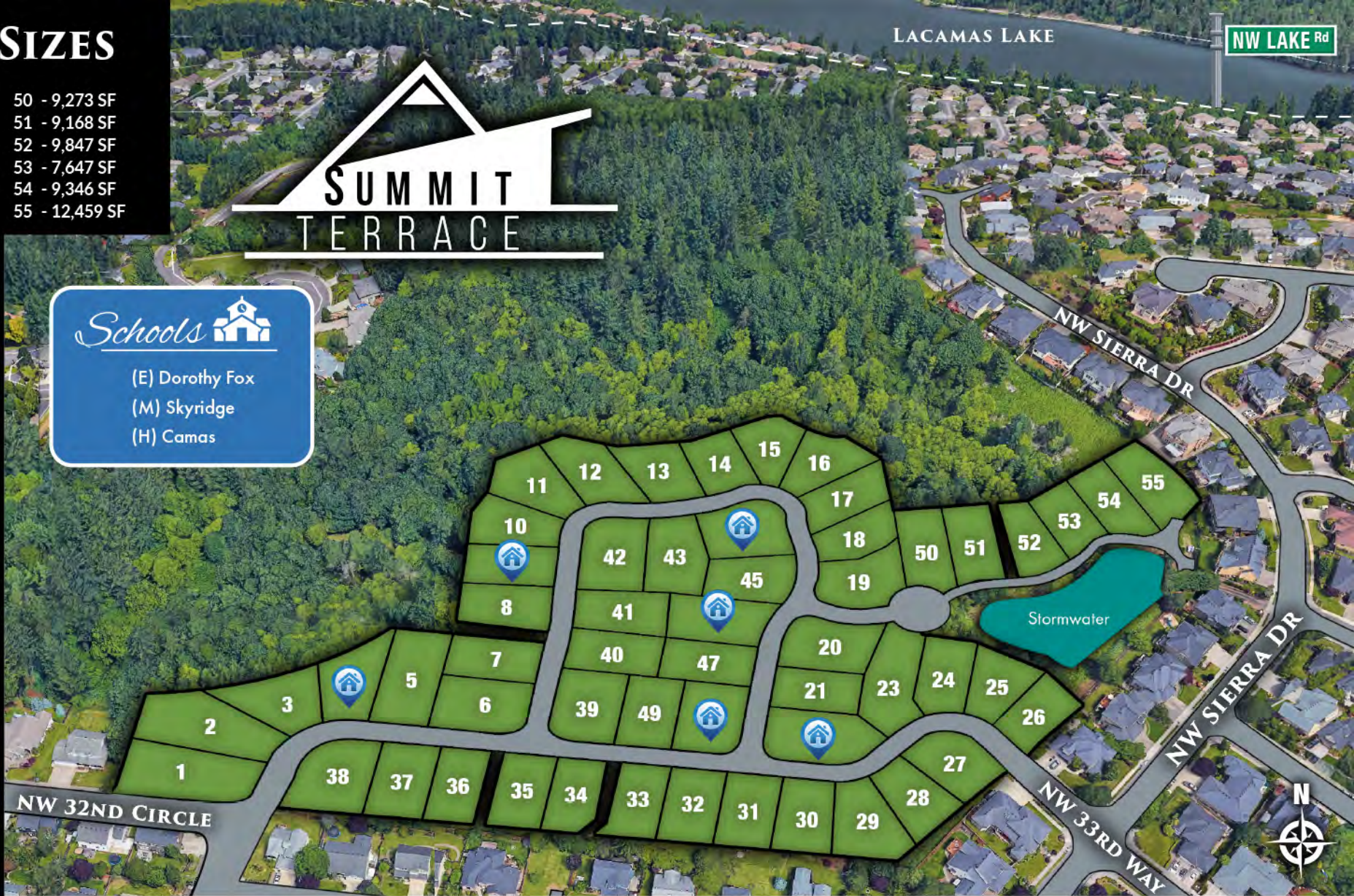

● AVAILABLE LOTS    
 🏠 MODEL HOME    
 🏠 CURRENTLY RESERVED    
 🏠 SOLD

● Greenbelted ● Southern Exposure ● Top-Tier Schools ● Close to Lacamas Lake & Nearby Parks

Currently preparing for groundbreaking - we are set to premier a housing community on the highly desirable Prune Hill in Camas. This peaceful setting offers territorial views of nearby Lacamas Lake and the surrounding area. This community is scenic, but accessible — within 5 min of Downtown Camas, 30 min to Downtown Portland and 20 min to Downtown Vancouver.



Ron Wagner  
360.907.4739



Jason Stenersen  
360.772.2357



Ala Malyakin  
360.261.0300

